

CAMPUS MAKER ECO™ MODULAR CLASSROOM

REDUCED CARBON FOOTPRINT DESIGN



THE SMART MODULAR SOLUTION

The Campus Maker Eco is designed to provide students and teachers a superior learning environment, while also conserving energy and maximizing space requirements.

Mobile Modular's Campus Maker Eco is the only readily available classroom for lease that meets current energy and structural requirements. The Eco's highly efficient HVAC system, combined with insulation values, EPDM roof and low-e insulated windows, all work in concert to **reduce energy consumption by as much as 38%**.

MODULAR CLASSROOM BUILDINGS

24' X 36' CLASSROOM

*optional restroom

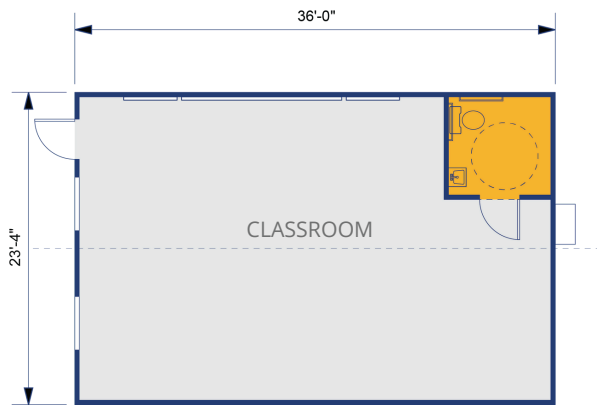

TRADITIONAL PORTABLE CLASSROOMS

Minimum of 20' separation between classrooms

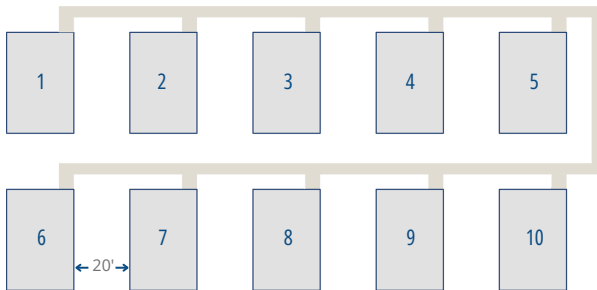

CAMPUS MAKER ECO MODULAR CLASSROOMS

Can be installed side-by-side

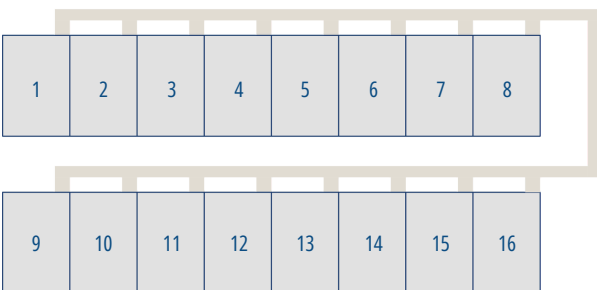

**All dimensions are nominal. Unless noted, equipment and related furnishing, finishes, accessories and appliances provided are previously leased. Materials, dimensions and specifications vary.

Fixture count, floorplans and available sizes may vary. Please contact your modular building expert for further information. Specifications are subject to change without notice.

Building Set Capabilities

- Classroom threshold heights can be set at 14" above grade, eliminating the need for ramps and/or stairs
- One-hour fire rated long walls allow classrooms to be set next to one another, creating a campus classroom wing

Interior Features

- Highly energy efficient HVAC with programmable thermostat
- Ducted air supply distributes air quietly, efficiently, and evenly to help create a superior learning environment
- A rigid floor system consisting of perimeter steel chassis with steel purlins and R-24 insulation further enhances the quiet and comfortable learning environment
- Floor finished with high quality carpet
- Drop ceiling with 2' x 2' acoustic tiles

Exterior Features

- Walls are steel stud construction covered with Structural Insulated Panels (SIP) and an attractive stucco texture finish. A rigid R-26 insulation and Vinyl Coated Gypsum makes for an energy efficient assembly.
- Energy efficient roof system includes R-24 insulation with a white EPDM rubber roof
- Mono-pitch roof design with a 2" rear overhang diverts rainwater from draining onto exterior openings
- Wind Velocity rating of 186 Vult meets all wind zone requirements in Florida, including Miami-Dade. The classroom satisfies FBC 2410.2 with its High Velocity Hurricane Zone (HVHZ) rating and missile impact resistance.

Optional Features

- Classroom Furniture
- Breakroom Accessories
- Site Related Services
- Permitting
- Skirting
- Custom Cabinets
- Air Care Solutions

Your Project — Our Commitment

866.889.7777 • mobilemodular.com

